

TECHNICAL DRAWING / DESSIN TECHNIQUE

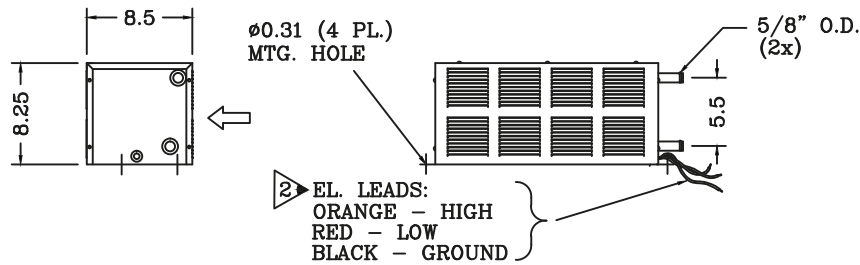
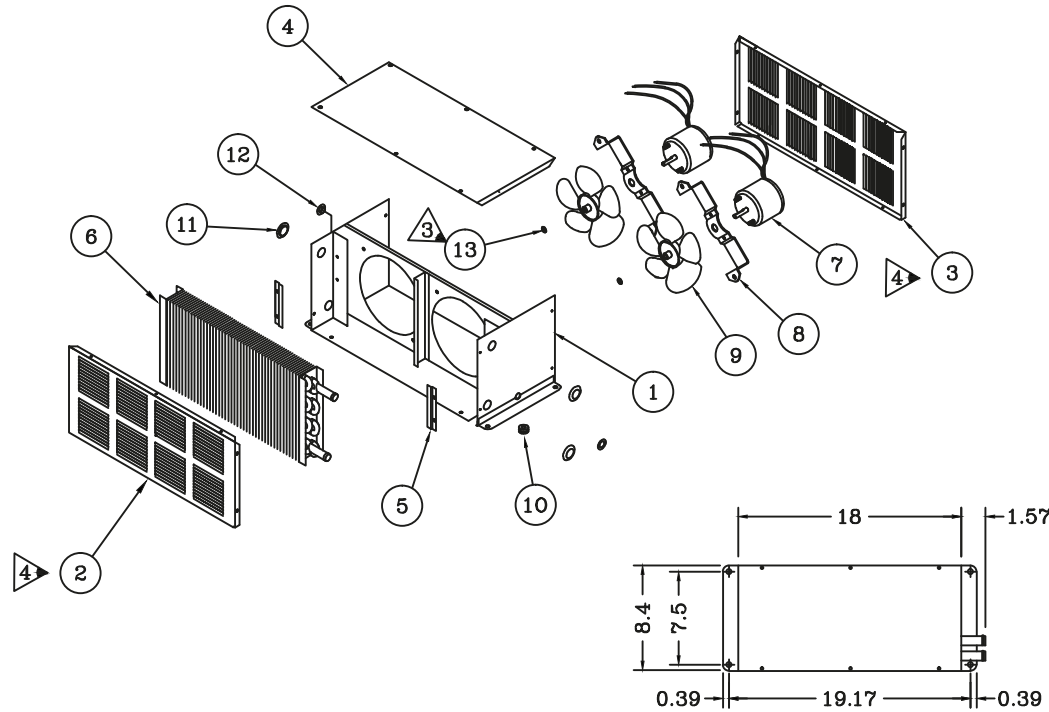

SPECIFICATIONS:

HEATING -42000 BTU/H (AT 150°F T.D)
 AIRFLOW -500 CFM
 CURRENT -11.6 AMPS (AT 12V)
 WEIGHT -18.5 LBS.

2-SPEED OPERATED MOTORS

THE HEATER COIL IS REVERSIBLE FOR LEFT HAND CONNECTION.

CASING MADE OF 18GA. CRS. AND FINISHED IN BLACK SEMI-GLOSS EPOXY POWDER COAT.

JIMEXS

HARDWARE

1 866 447-5656 / INFO@JIMEXS.COM

WWW.JIMEXS-HARDWARE.COM

805-504

Heater 12V - 11.6 Amp
 Chaufferette 12V - 11.6 Amp

2022-03-01

PROJECTIONS

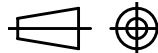

DIMENSIONS
 SPECS

19,17"Lo x 7,50"La x 8,25"H
 42,000 BTU - 500CFM
 Rear connection / Tuyau à l'arrière